

# Alustar

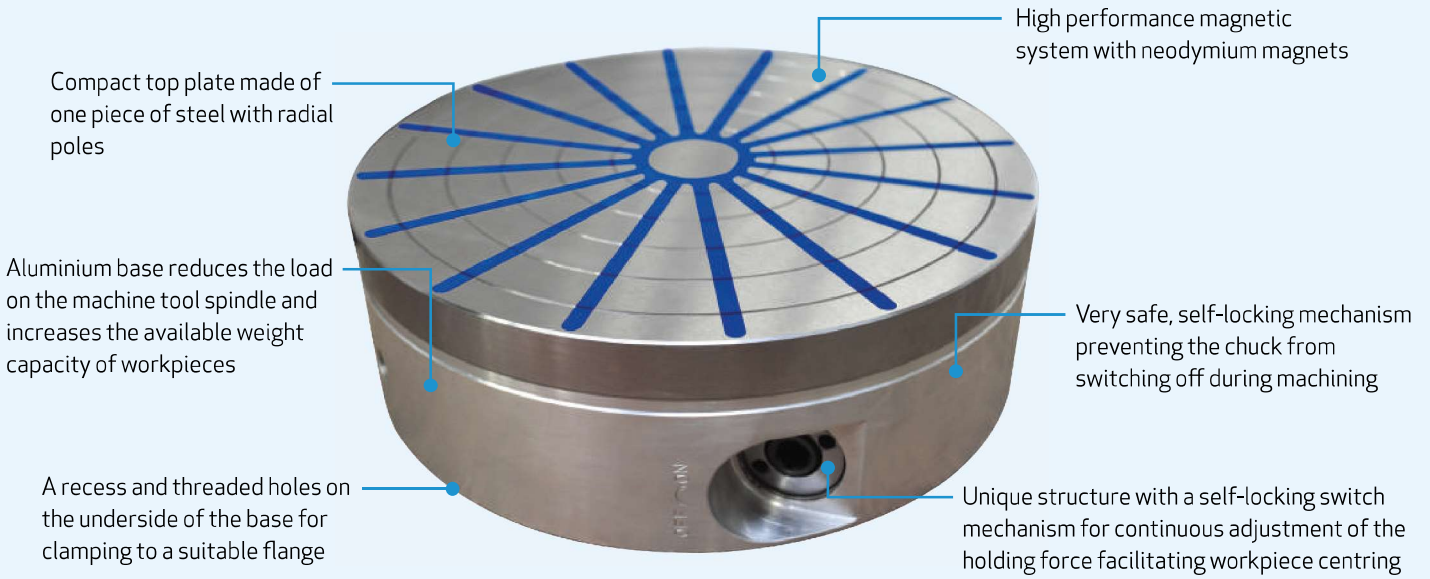

## When to choose an Alustar permanent magnetic chuck:

The Alustar permanent chuck is used during turning and grinding of ring-shaped workpieces. The chuck excels due to its low weight resulting from the aluminium design of the body. It can cope with a larger weight range of machined components. With this chuck, you have the possibility to machine the front, inner and outer diameter of the workpiece in one operation.

### APPLICATION



Turning

### TECHNOLOGY



Permanent

### DIAMETER



from 200 mm

### HOLDING FORCE



140 N/cm<sup>2</sup>

### POLES



Radial

### Important parameters:

Application:	Turning, circular grinding
Technology:	Permanent
Holding force:	140 N/cm <sup>2</sup>
Min. workpiece size:	40 mm
Poles:	Radial
Regrinding limit:	5 mm

### Use:

- + turning and grinding of round and ring-shaped workpieces

Model	D (mm)	H (mm)	D1 (mm)	E (mm)	F (mm)	Weight (kg)
ALUS20D200	200	79	20	110	180	11,5
ALUS20D250	250	79	30	166	220	18
ALUS20D300	300	82	38	180	260	27
ALUS20D350	350	84	40	220	300	36
ALUS20D400	400	84	40	260	340	47
ALUS30D500	500	109	50	330	400	98
ALUS30D600	600	109	90	350	450	142

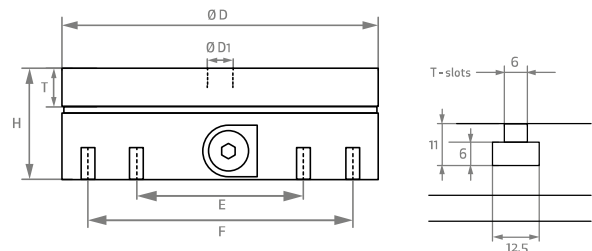

For more information, visit [www.walmagmagnetics.com](http://www.walmagmagnetics.com)